



POWERFUL



COMPLETE RANGE



RELIABLE AND STURDY



Ditec Cross

EN

Automation system for sliding gates
up to 3000 Kg

Ditec Cross

Ditec Cross is the range of operating devices for sliding gates that meets all the various requirements for use in commercial, industrial and residential contexts, guaranteeing the maximum in safety and reliability. The **gear motor is available in three different solutions**, with or without control panel.

Ditec Cross 18 and Ditec Cross 19

For sliding gates **up to 1800 Kg.**
Ideal for **intensive use**

Ditec Cross 30

For sliding gates **up to 3000 Kg.**
Ideal for **continuous use (100%)**

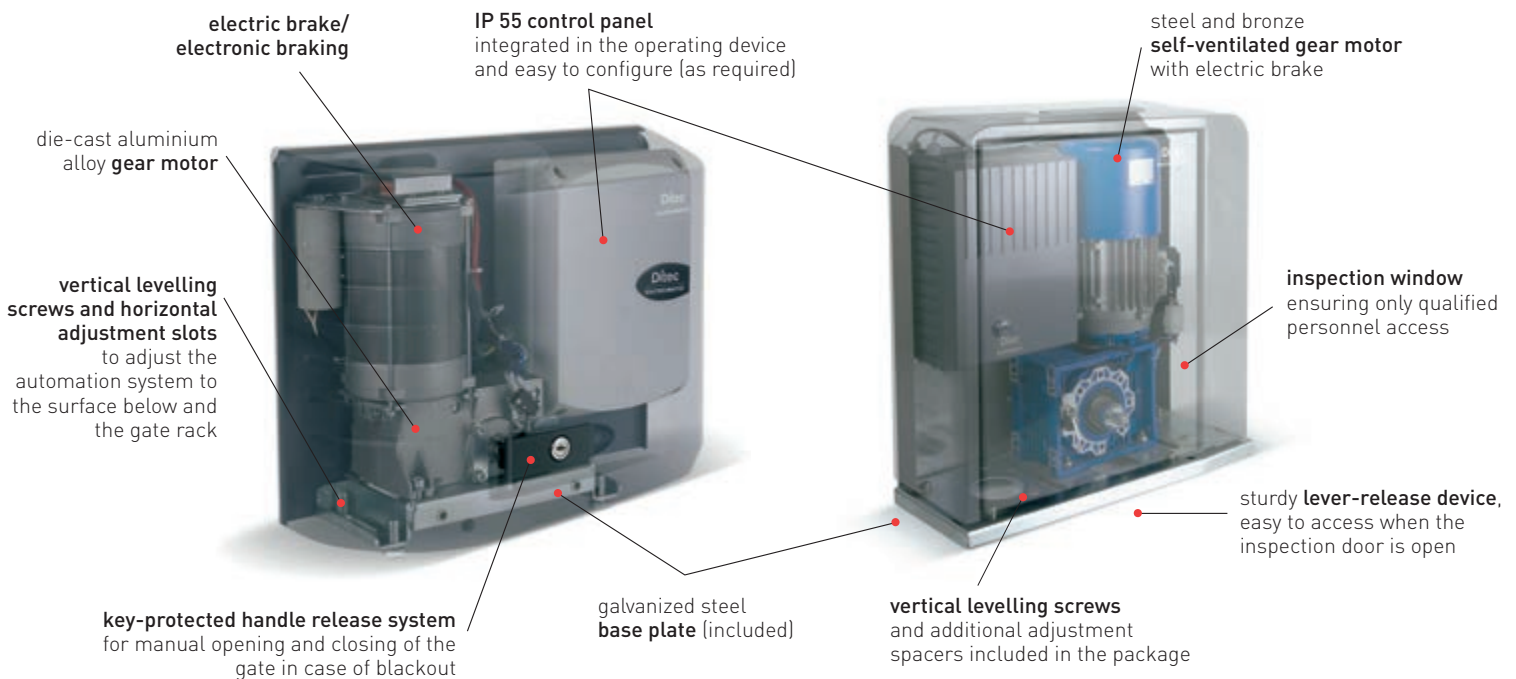

RELIABLE and STURDY,
an automation system designed to last

- **steel worm screw** for **CROSS 18 and 19**; cemented, tempered and adjusted screw with a bronze crown for the **CROSS 30E** model
- **lubricating grease** suitable for temperatures ranging from **-35°C** to **+55°C** for **CROSS 18 and 19** and **oil bath** for **CROSS 30E**
- high-reliability **control panels** with sturdy contacts
- **irreversible gear motor** to avoid installation of electro-mechanical locks
- **Safety-Test function**
- **electric brake and electronic clutch** to guarantee irreversibility and precise stopping points

OUR EXPERTISE AT YOUR SERVICE

A complete range. A dedicated team of specialists. Excellent technology and design. Passionate about being different. **Entrematic** is a commercial partner with a complete range in the entrance-automation sector, which combines specialised know-how and high-profile brands. **The Ditec brand**, has been a world leader for more than 40 years, offering a complete range of automation systems for gates, automatic doors and rapid doors.

Normstahl
ENTRE/MATIC

DYNACO
ENTRE/MATIC

Ditec
ENTRE/MATIC

em
ENTRE/MATIC

KELLEY
ENTRE/MATIC

SERCO
ENTRE/MATIC

Amarr
ENTRE/MATIC



POWERFUL

Single-phase electronic (230 V) and three-phase electronic (400 V) guarantee maximum performances even under adverse conditions, thanks to greater dynamic thrust during the initial phase of operation.



COMPLETE RANGE

5 versions available:

- two 1800 kg versions without control panel, one single-phase and one three-phase
- two 1800 kg versions with control panel, single-phase
- one 3000 kg version with control panel, three-phase

Example of installation

Discover the entire range of Ditec brand products and specific accessories at www.ditecentrematic.com

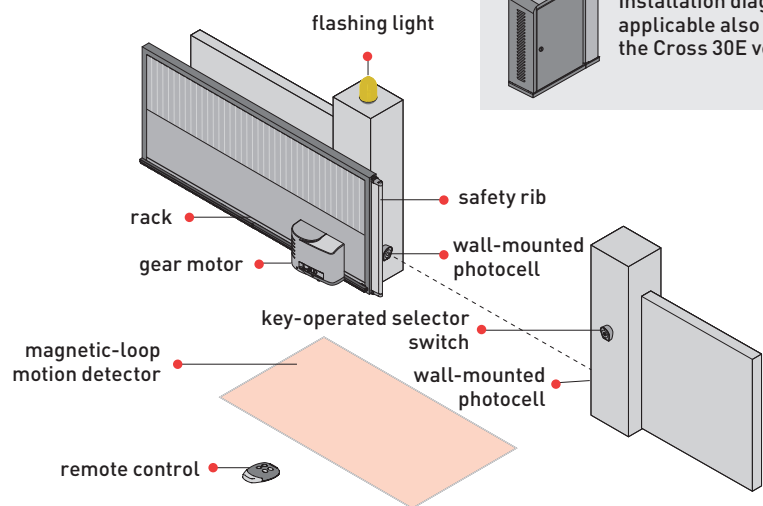

FULL COMPLIANCE WITH EU DIRECTIVES AND STANDARDS



- 2014/30/EU - EMCD - Electromagnetic Compatibility Directive
- 2014/53/EU - RED - Radio Equipment Directive
- 2006/42/CE - Machines Directive - (Annex II-B; Annex II-A; Annex I-Chapter 1)

Ditec Cross 18 - Ditec Cross 19

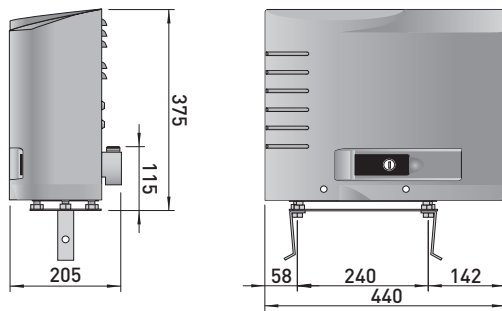

Ditec Cross 30

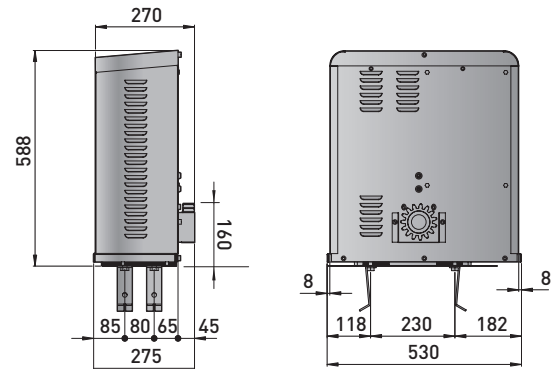

Technical specifications

| Description | Cross 18 | Cross 18E | Cross 18VE | Cross 19V | Cross 30E |
|-------------------------------------|--|-----------------------------|-------------------------|-------------------------|-----------------------|
| Max. leaf weight | 1800 kg | 1800 kg | 1800 kg | 1800 kg | 3000 kg |
| Stroke control | rotary limit switch | lever-operated limit switch | magnetic limit switch | magnetic limit switch | magnetic limit switch |
| Duty class | 4 - heavy duty | 4 - heavy duty | 4 - heavy duty | 4 - heavy duty | 5 - very heavy duty |
| Intermittent operation | S2 = 30 min S3 = 50% | S2 = 30 min S3 = 50% | S2 = 30 min S3 = 50% | S2 = 30 min S3 = 50% | S3 = 100% |
| Power supply | 230 V AC - 50 Hz | 230 V AC - 50 Hz | 230 V AC - 50 Hz | 400 V AC - 50 Hz | 400 V AC - 50 Hz |
| Power input | 3 A | 3 A | 3 A | 1.2 A | 2.1 A |
| Thrust | 1200 N | 1200 N | 1200 N | 1500 N | 3000 N |
| Opening and closing speed | 0.2 m/s | 0.2 m/s | 0.2 m/s | 0.2 m/s | 0.16 m/s |
| Maximum opening | 11 m | 20 m | 20 m | 20 m | 20 m |
| Release system for manual opening | key-operated | key-operated | key-operated | key-operated | lever |
| Automation system protection rating | IP 24D | IP 24D | IP 24D | IP 24D | IP 45 |
| Operating temperature | -20°C / +55°C [-35°C / +55°C with NIO enabled] | | | -20°C / +55°C | |
| Control panel | E1A or LOGICM (on request) | E1A (integrated) | LOGICM (integrated) | E1T (on request) | E1T (integrated) |

Main functions of the system

| Control panel | E1A | LOGIC M | E1T |
|------------------------------------|-------------------------|---------------------------|---------------------|
| Radio incorporated | ■ | on request | on request |
| Mains power supply | 230 V AC / 50/60 Hz | 230 V AC / 50/60 Hz | 230 V AC / 50/60 Hz |
| Motor power supply | 230 V AC / 5 A | 230 V AC / 1 x 5 A | 400 V AC / 6 A |
| Accessories power supply | 24 V DC / 0.5 A | 24 V DC / 0.5 A | 24 V DC / 0.5 A |
| Flashing light | 230 V AC | 230 V AC and 24 V DC | 24 V DC |
| Gate open warning light | limit switch | limit switch and analogue | limit switch |
| Courtesy light | ■ | ■ | |
| Limit-switch provision | ■ | ■ | ■ |
| Force setting | transformer | transformer | |
| ODS - Obstruction Detection System | ■ | ■ | |
| Time setting | ■ | ■ | |
| Open control | ■ (with dip-switch) | ■ | ■ (with dip-switch) |
| Partial opening control | ■ (remote control only) | ■ | ■ |
| Close control | ■ | ■ | ■ |
| Timer controlled automatic closing | ■ | ■ | ■ |
| Inching control | ■ | ■ | ■ |
| Hold-to-run control | ■ | ■ | ■ |
| Emergency stop | ■ | ■ | ■ |
| Emergency reverse | ■ | ■ | ■ |
| Safety test function | ■ | ■ | ■ |



Entrematic Italy S.p.A.

Largo U. Boccioni, 1 • 21040 Origgio (VA) • Italy

Tel +39 02 963911 • Fax: +39 02 9650314

ditec@entrematic.com

www.ditecentrematic.com • www.entrematic.com

Cod. N210B - 11/2016
Ditec Cross

RED APPLE INTERNATIONAL

